



2090 INTERPROVINCIAL HIGHWAY, ABBOTSFORD

20.34 ACRES · HOUSE & ACREAGE | BLUEBERRY



FARMS IN BC
REAL ESTATE GROUP

Previous Price: ~~\$3,488,000~~

PRICE \$3,299,000

Frontage: 518.11 ft

Depth: 1,712.43 ft

ABOUT THE PROPERTY

20.34 Acre blueberry farm planted with Elliot, Reka, and Duke variety blueberries. Very well maintained and high producing, with 275,000 lb average production. Property also has a 924 sq ft 2 bed/1 bath home and an 1,800 sq ft shop, both of which are currently tenanted.

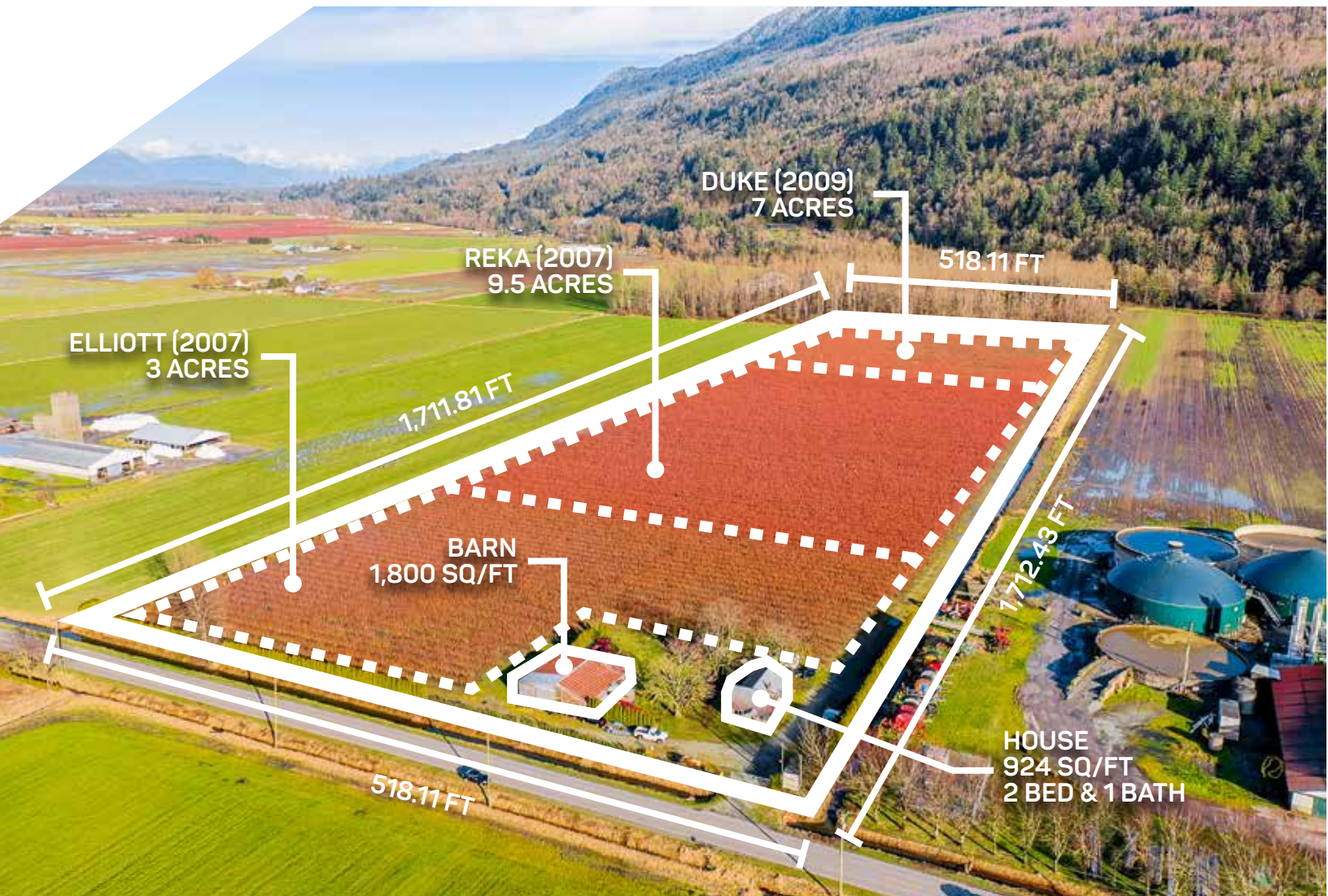

- PID 010-837-931
- MLS R2535366
- GROSS TAX \$3,034.87 - 2020
- ZONING A-2

DUE DILIGENCE DOCUMENTS

- Title Search
- Property Disclosure Statement (Upon Accepted Offer)
- Zoning Document





NAV SEKHON

604.782.0988

info@farmsinbc.com

exp
REALTY

farmsinbc.com

Farms in BC. All rights reserved. Content may not be reproduced, copied, altered, distributed, stored or transferred in any form or by any means without express written permission. Locations, dimensions, specifications, prices and features are approximate and subject to change without notice. Not intended to solicit properties currently listed for sale or individuals currently under contract with a Brokerage.