



**6716 168 STREET, SURREY**

18.97 ACRES • HOUSE & ACREAGE



**FARMS IN BC**  
REAL ESTATE GROUP



## ABOUT THE PROPERTY

18.97 ACRES, HOUSE AND ACREAGE! Fantastic location to build your dream home with access to all utilities, out of the flood plain, option to build a 3-story home at 7,500 SQ/FT. The property has a 1,265 SQ/FT Home with 3 Bedrooms and 1 Bathroom, 4,000 SQ/FT, and 1,050 SQ/FT Barns. Centrally located and neighboring Northview Golf Course with amazing valley views. Close to all amenities; schools, transit, and shopping. Easy access to Highway #10, Highway #15, Highway #1, and the USA Border.

**PRICE \$3,988,000.00**

**Frontage:** 188 ft (168 Street)

**Depth:** 2,472.51 ft



- PID 011-393-335
- MLS R2756335
- GROSS TAX \$734.40 - 2022
- ZONING A-1

### DUE DILIGENCE DOCUMENTS

- Title Search
- Property Disclosure Statement (Upon Accepted Offer)
- Zoning Document







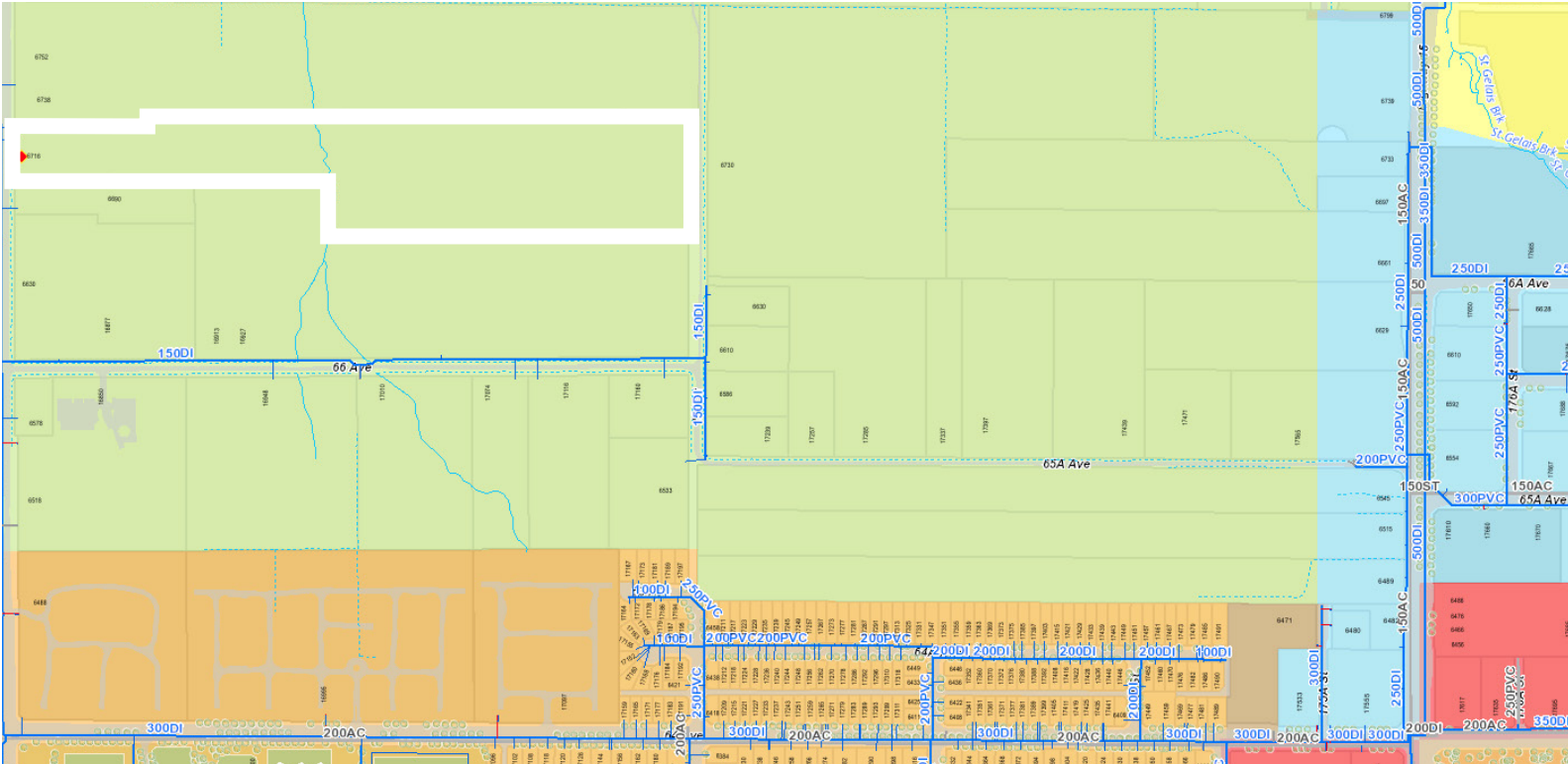

Urban / Residential



Industrial / Commercial

**NAV SEKHON**

**604.782.0988**  
 nav@farmsinbc.com



**farmsinbc.com**

Farms in BC. All rights reserved. Content may not be reproduced, copied, altered, distributed, stored or transferred in any form or by any means without express written permission. Locations, dimensions, specifications, prices and features are approximate and subject to change without notice. Not intended to solicit properties currently listed for sale or individuals currently under contract with a Brokerage.