



**8476 184 STREET, SURREY**

5.00 ACRES • LAND ONLY



**FARMS IN BC**  
REAL ESTATE GROUP

## ABOUT THE PROPERTY

**5 ACRES - PRELOADED AND READY TO BUILD** in Port Kells. Ready to build a 5,400 SQ/FT Home on a 20,000 SQ/FT Pre-load pad and ready to build a Building on a 7,308 SQ/FT Pre-load pad. Great location to build your dream home and/or start a hobby farm. Fertile soil suitable for various crops, fruits & vegetables. Easy Access to Highway #15 (176 Street), Fraser Highway, Highway #1 (Trans-Canada), and Golden Ears Way. Close to all amenities.

**PRICE \$2,988,000**

**Frontage:** 255.11 ft (184 Street)  
**Depth:** 842.94 ft

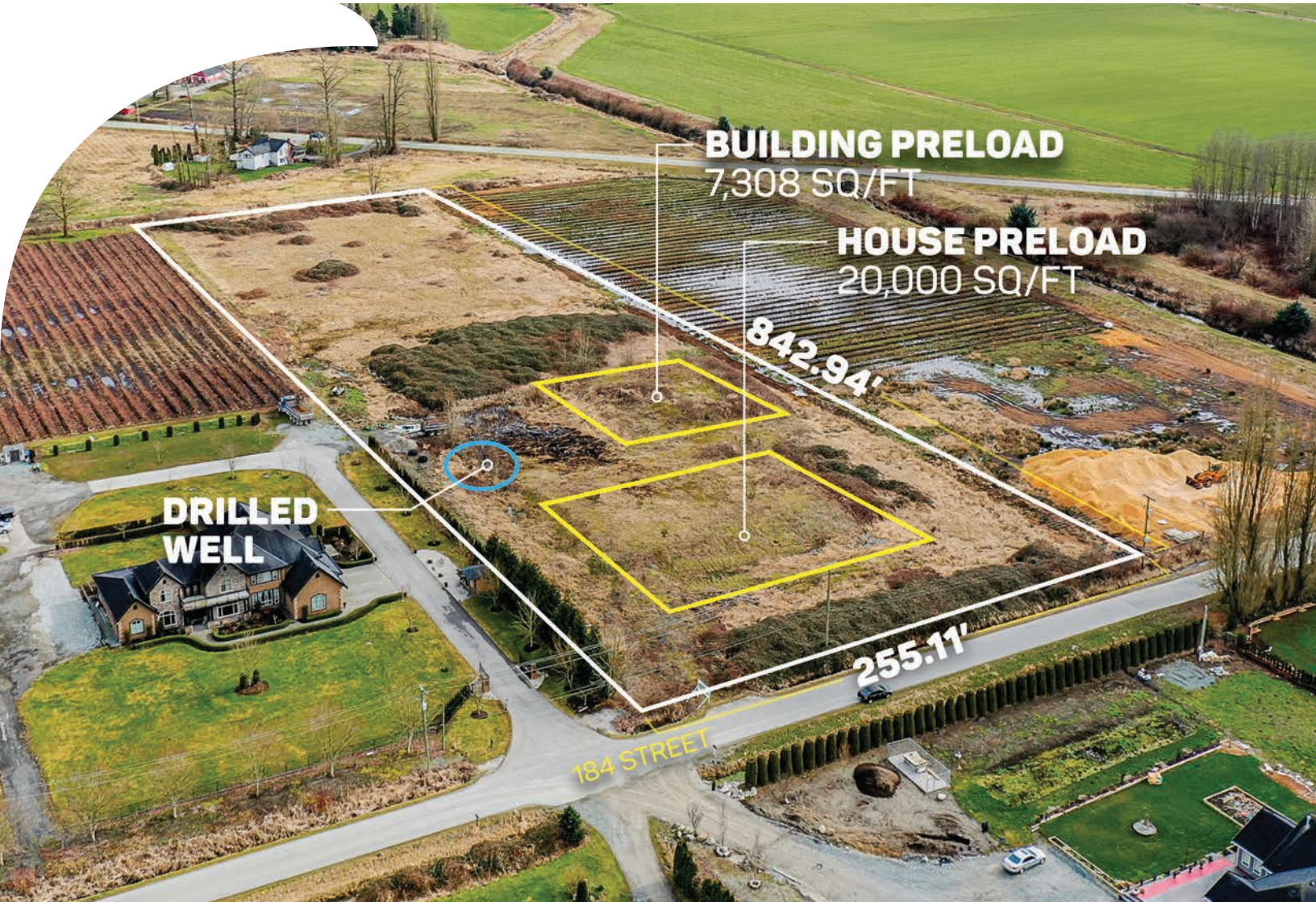

- PID 012-013-170
- MLS R2862300
- GROSS TAX \$5,703.24 - 2023
- ZONING A-1

### DUE DILIGENCE DOCUMENTS

- Title Search
- Property Disclosure Statement (Upon Accepted Offer)
- Zoning Document





**NAV SEKHON**

**604-782-0988**

[nav@farmsinbc.com](mailto:nav@farmsinbc.com)

**exp**  
REALTY

**farmsinbc.com**

Farms in BC. All rights reserved. Content may not be reproduced, copied, altered, distributed, stored or transferred in any form or by any means without express written permission. Locations, dimensions, specifications, prices and features are approximate and subject to change without notice. Not intended to solicit properties currently listed for sale or individuals currently under contract with a Brokerage.